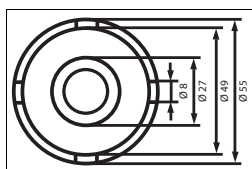

KL-0140-2 Meter for Coefficient of Friction

For accurate adjustment of bearing pre-load when repairing Steering Racks, Gearboxes, Differentials, etc.

Technical Data:

Measuring range:	0 - 6 N
Drive:	1/2"

KL-0301 Toothed Socket Rear Axle Drive Shaft Flange MB

Suitable for Mercedes W116, W123, W126 Rear Axle Drive Shaft Flange.

Technical Data:

Drive:	3/4"
Length:	80 mm
Weight:	420 g

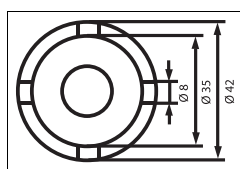
KL-0302 Toothed Socket Gearbox Flange MB

Suitable for Mercedes Gearbox Flange.

Technical Data:

Drive:	3/4"
Length:	70 mm
Weight:	440 g

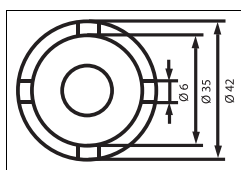
KL-0303 Toothed Socket Differential Flange MB

Suitable for Mercedes Differential Flange.

Technical Data:

Drive:	3/4"
Length:	70 mm
Weight:	370 g

KL-0304 Special bi-hex Socket 30 mm

Suitable for BMW 3 series (E36, E46); Citroen Saxo; Ford Galaxy; Mercedes E-Class (W211), C-Class (W203), SL (W129), W123, W124, W126, W201; Opel Astra F, Astra G; Renault Scenic, Clio, Kangoo; Toyota Avensis, Picnic und VW Golf (III, IV), Lupo, Touareg, T5 etc.

The special socket is particularly suitable for loosening and tightening the mounting nut, for example, on rear or front axle drive shafts, on wheel bearings. as well as on gearbox or differential flange.

Technical Data:

Size (width across flats):	30 mm
Profile:	bi-hex
Drive:	1/2"
Length:	80 mm
Weight:	350 g

KL-0305 Special bi-hex Socket 32 mm

Suitable for Fiat Punto; Ford Escort, Mondeo; Mercedes S-Class (W140); Nissan Almera, Opel Astra H, Vivaro; Subaru Outback etc.

The special socket is particularly suitable for loosening and tightening the mounting nut, for example, on rear or front axle drive shafts, on wheel bearings. as well as on gearbox or differential flange.

Technical Data:

Size (width across flats):	32
Profile:	bi-hex
Drive:	1/2"
Length:	75 mm
Weight:	450 g